



Launched in 2010, Black & White is a magnificent Sunseeker 34 Metre. A special version of this semi-custom range, she benefits from many high-end upgrades, most evident in the vessel's interior. The distinctive black-and-white theme is based on the ying-yang symbol. A Chinese sign for complementary opposites, it perfectly sums up the mix of performance and luxury guests experience onboard this stunning vessel.

Space is a continuing theme on the sizeable flybridge which, with its outdoor jacuzzi and enlarged bar, provides an alternate living area as well as the ideal place for a sundowner – ending another perfect day aboard.

1 Aft deck
2 Sundeck
3 Aft deck



4

Black & White is very much a boutique villa on water, with Fendi furniture and a stunning black-and-white theme which elegantly sets this vessel apart from the competition. As befitting such a yacht, entertainment in the saloon comes courtesy of a state-of-the-art Bang & Olufsen lifestyle system and a majestic 50" flatscreen television.

4 Saloon



Dining is a sumptuous experience onboard Black & White, with Frette linen and designer accessories. The wall is adorned with a magnificent Philip Stark mirror, a stunning piece of design which not only elevates the room but also extends the feeling of space and light.

- 1 Dining table
- 2 Fendi cushion
- 3 Dining detail
- 4 Saloon



Below decks, the luxury continues. Guests fortunate enough to sleep in the master cabin can relax in the magnificent Fendi king-sized bed, gold mosaic steam shower and upgraded jacuzzi. The cabin also features a uniquely designed window which allows guests to look out to sea whilst luxuriating in the comfort of their cabin.

The remaining four cabins – two queen and two twin bedrooms, all en suite – don't stint on comforts either, with Frette linen and towels, and the latest entertainment systems.

- 5 Master cabin
- 6 Master en suite
- 7 Detail
- 8 Queen cabin
- 9 En suite



The exterior of Black & White boasts all manner of luxuries to make life onboard one of unbridled fun. The sundeck offers an extended bar and dining area, ice maker, fridge and barbeque. There's also a hot tub, extensive sunbathing area at the aft of the sundeck and a tropical misting system to keep guests cool on balmy summer nights. A custom-made Castoldi 16ft tender – black, to match the boat – provides a stylish way to reach shore.

- 1 Stern
- 2 Tender
- 3 Sundeck
- 4 Sundeck
- 5 Sundeck



The crew areas are all finished to high standards. There's comfortable leather seating in the bridge should guests want to help the captain navigate, while the engine room is fitted with a state-of-the-art Kohler and MTU engine system. The galley is fully equipped with the latest technology, ample pantry storage and customizable cold storage so entertaining onboard is a seamless experience. For the benefit of both crew and guests, there are zero-speed stabilizers, ensuring the upmost comfort when at anchor.

6 Bridge
7 Engine room
8 Galley

SPECIFICATION

Length overall:	33.91m
Beam – (maximum):	7.39m
Height above waterline:	7.20m
Draft – (at full load):	2.28m
Displacement @ half load:	119700kg
Fuel capacity:	19500 litres
Fresh-water capacity:	4000 litres
Engines:	Twin MTU 16v 2000 M93 series
Stabilizers:	Zero speed (underway & at anchor)

PERFORMANCE

Cruising speed:	20 knots
Fuel consumption – (cruising speed):	900 litres ph
Range – (cruising speed):	up to 440 miles
Max Speed:	25 knots

EQUIPMENT

Satellite TV system
50" TV in saloon
B&O lifestyle system
TVs & entertainment systems in all cabins
Satellite phone system
Internal phones
Air-conditioning
16ft custom – made Castoldi tender
2 x jet ski Seadoo 255
Watertoys

ACCOMMODATION

10 guests in 5 cabins
1 master stateroom
2 double guest staterooms
2 twin/double guest cabins
Accommodation for 5 crew
Max 11 guests on day charter plus 5 crew

FLYBRIDGE

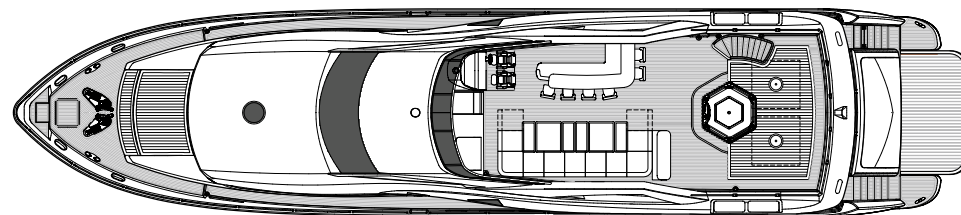

WHEELHOUSE

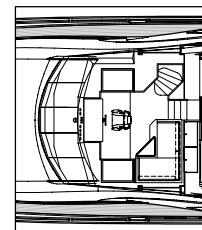

MAIN DECK

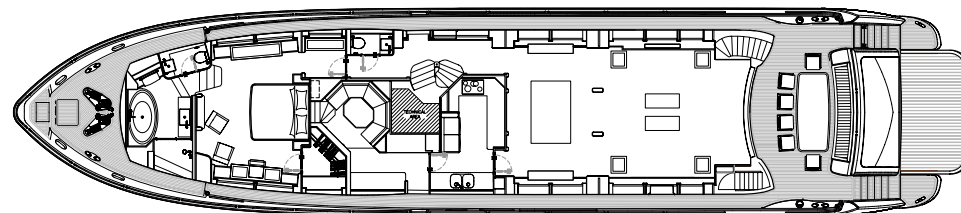

LOWER DECK

